

Unverbindliche Visualisierung

**BAU
STOLZ**

Ludwigsburg-Ossweil
Herrmann-Loens-Straße
Haus 14-16 - Jazz
Erdgeschoss

EG	44,24 m ²
Wohnen	10,69 m ²
Kochen	10,30 m ²
Essen/Eingang	12,43 m ²
WC	1,49 m ²
Terrasse (50%)	5,04 m ²
OG	38,25 m ²
DG	25,62 m ²
Wohnfläche ges. gem. WoFIV	108,11 m²

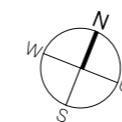
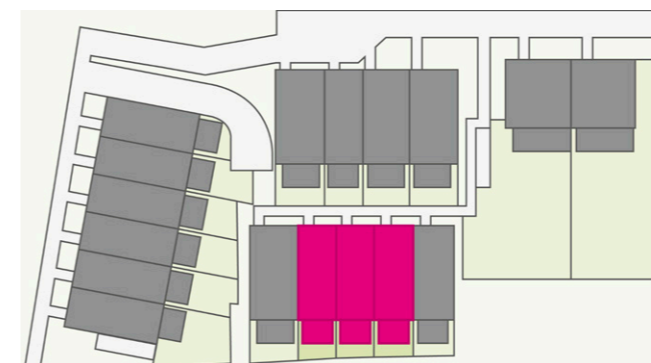

Haus 14-16

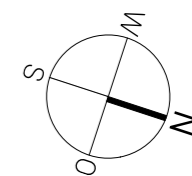

Maßstab 1:50



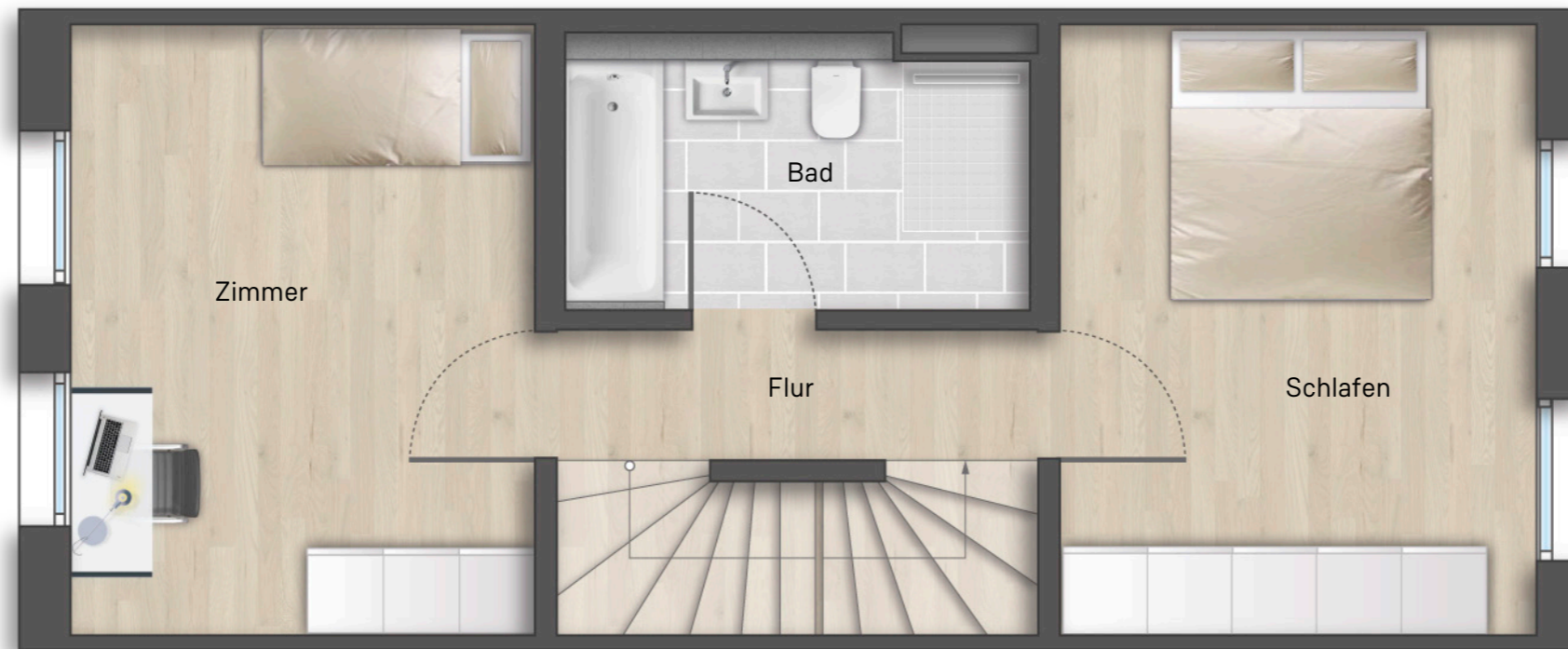

Unverbindliche Visualisierung

**BAU
STOLZ**

Ludwigsburg-Ossweil
Herrmann-Loens-Straße
Haus 14-16 - Jazz
Obergeschoss

EG	44,24 m ²
OG	38,25 m ²
Schlafen	14,20 m ²
Zimmer	14,55 m ²
Bad	6,29 m ²
Flur	3,21 m ²
DG	25,62 m ²
Wohnfläche ges. gem. WoFIV	108,11 m²

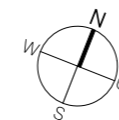
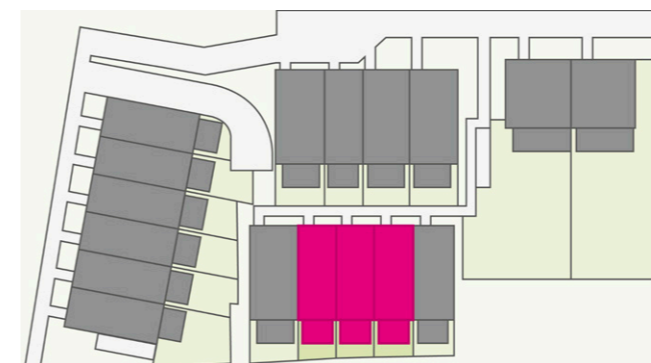

Haus 14-16

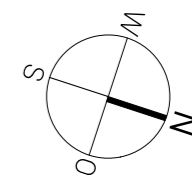

Maßstab 1:50



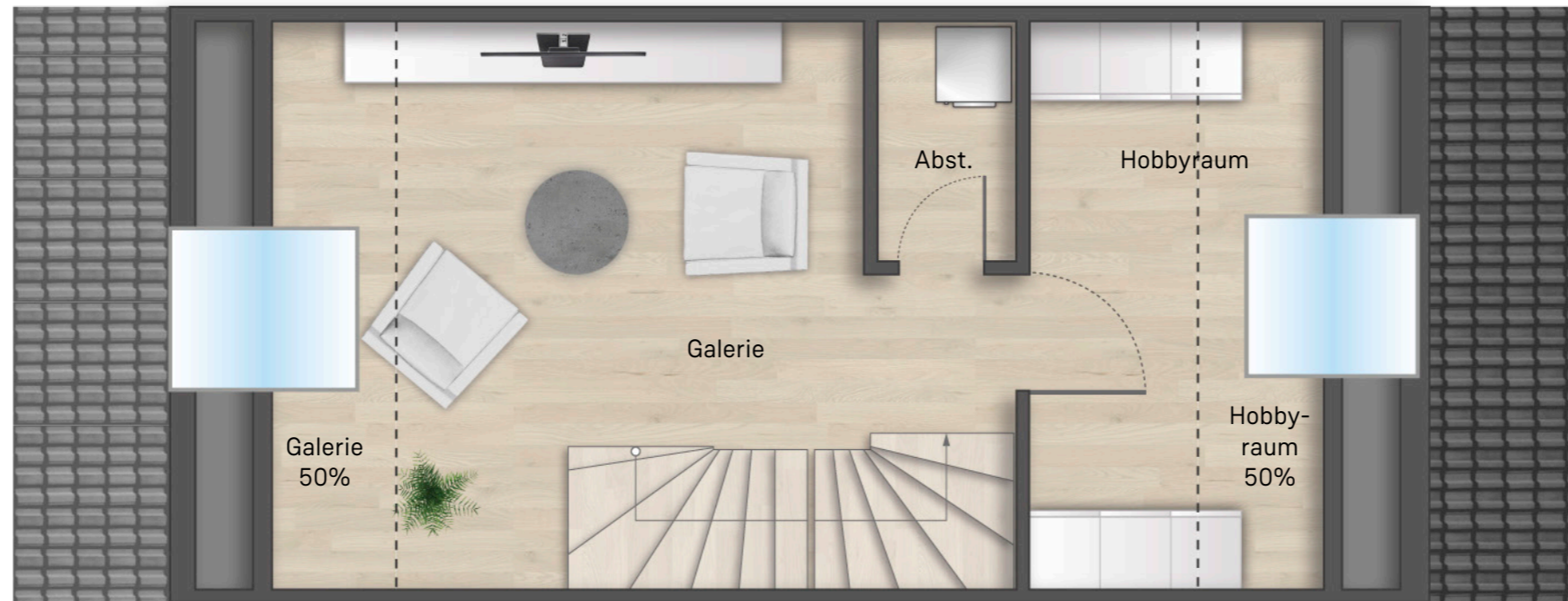

Unverbindliche Visualisierung

EG	44,24 m ²
OG	38,25 m ²
DG	25,62 m ²
Galerie	13,91 m ²
Galerie (50%)	2,57 m ²
Hobbyraum	4,83 m ²
Hobbyraum (50%)	2,57 m ²
Abstellraum	1,74 m ²
Wohnfläche ges. gem. WoFIV	108,11 m²

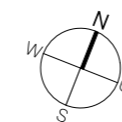
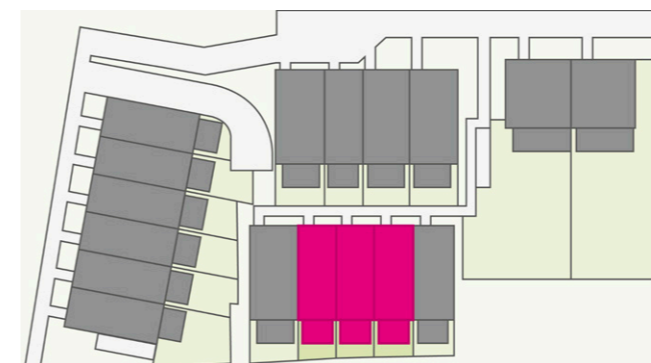

Haus 14-16

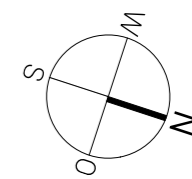

Maßstab 1:50

